

STATE	STATE PROJECT REFERENCE NO.	SHEET NO.
N.C.	44847.3.6	1
STATE PROJ. NO.		DESCRIPTION
44847.3.6		PE, CONST

STATE OF NORTH CAROLINA
DIVISION OF HIGHWAYS

MARTIN COUNTY

LOCATION: NC 11 FROM NC 903 TO MARTIN COUNTY /BERTIE COUNTY LINE

TYPE OF WORK: SINUSODAL MILLED RUMBLE STRIPS & INSTALL SNOW PLOWABLE MARKERS

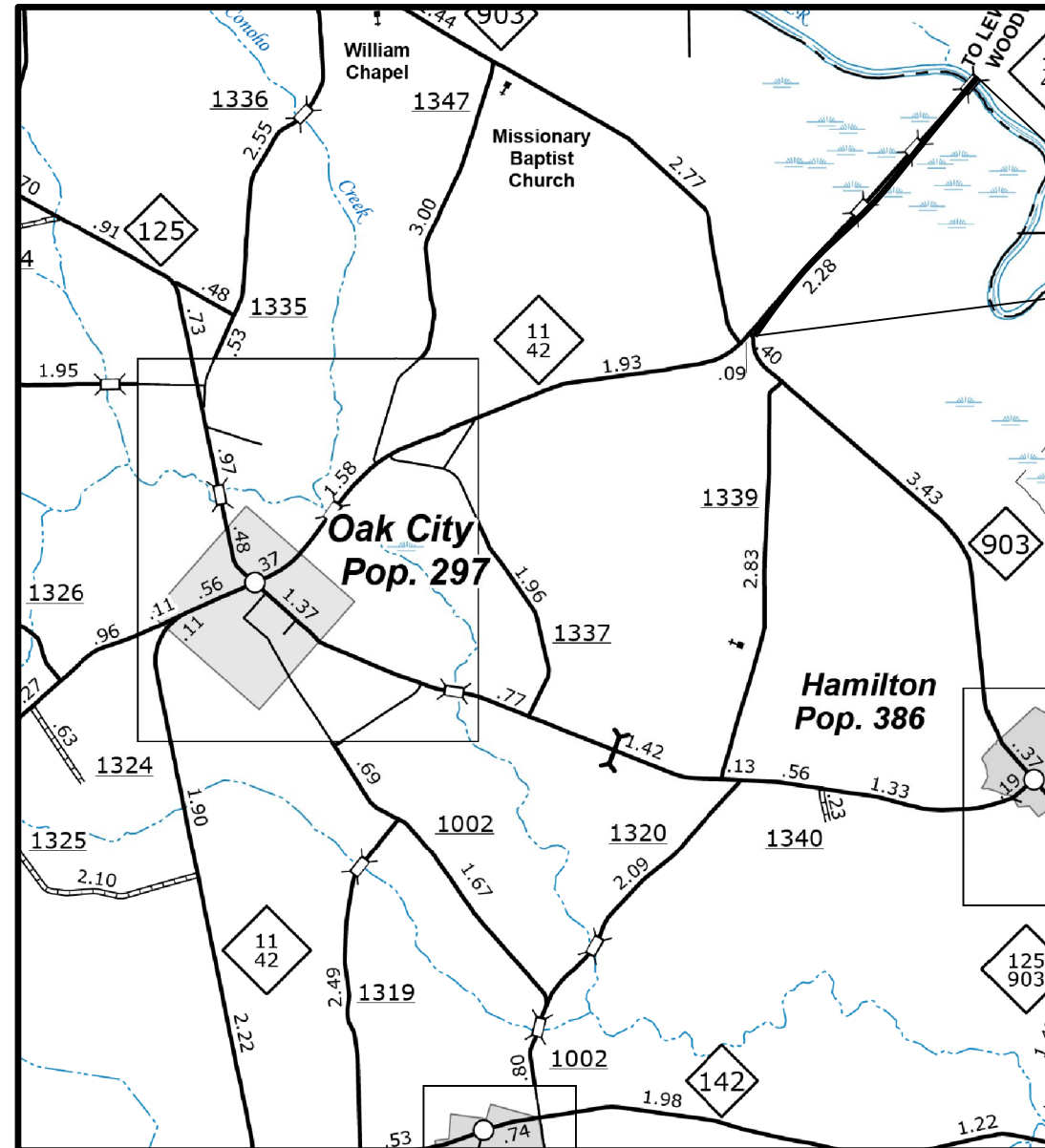

CONTRACT: DA00526 WBS PROJECT: 44847.3.6

GRAPHIC SCALES

NTS

PROJECT LENGTH

LENGTH ROADWAY MAP #1 = 2.0 MILES

Prepared in the Office of:
DIVISION OF HIGHWAYS
113 AIRPORT DR., EDENTON, NC, 27932

2018 STANDARD SPECIFICATIONS

W.B. HOBBS, P.E.
DIVISION PROJECT TEAM LEAD

CHRIS SLACHTA
DIVISION PROPOSALS ENGINEER

S.P. FENWICK, PLS
DESIGN ENGINEER

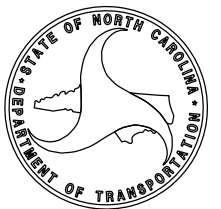

18-APR-2022 09:14 C:\Users\bkbrown5\Desktop\Misc. Projects\Martin\NC 44-HWY 11 Centerline Rumble Strips\Design Files\DA00526-SINUSOIDAL RUMBLE STRIPS.dgn \$\$\$USERNAME\$\$\$

STATE	STATE PROJECT REFERENCE NO.	SHEET NO.
N.C.	44847.3.6	2
STATE PROJ. NO.		DESCRIPTION
44847.3.6		PE, CONST

STATE OF NORTH CAROLINA
DIVISION OF HIGHWAYS

BERTIE COUNTY

LOCATION: NC 11 FROM BERTIE COUNTY LINE HERTFORD COUNTY LINE

TYPE OF WORK: SINUSOUDAL MILLED RUMBLE STRIPS & INSTALL SNOW PLOWABLE MARKERS

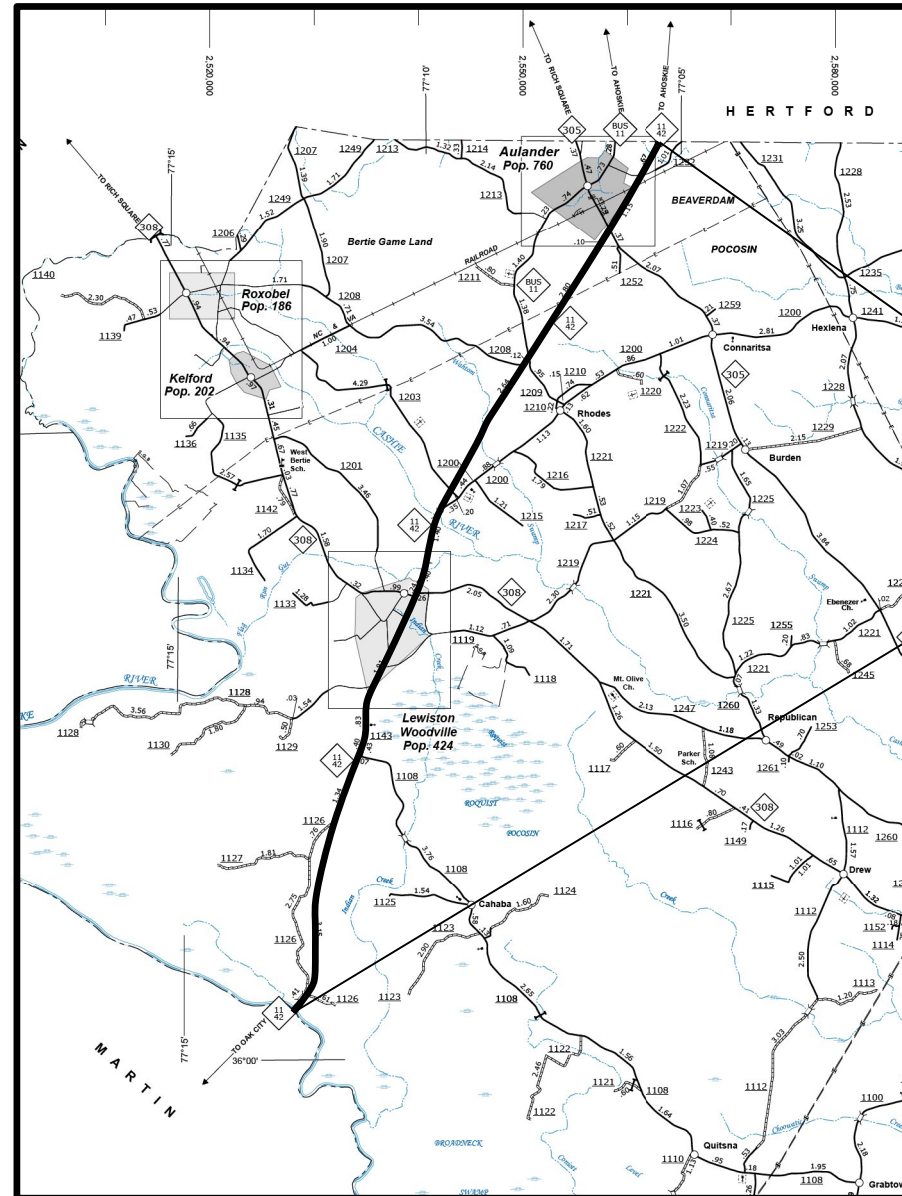

MAP 2

CONTRACT: DA00526 WBS PROJECT: 44847.3.6

GRAPHIC SCALES

NTS

PROJECT LENGTH

LENGTH ROADWAY MAP #2 = 17.0 MILES

Prepared in the Office of:
DIVISION OF HIGHWAYS
113 AIRPORT DR., EDENTON, NC, 27932

2018 STANDARD SPECIFICATIONS

W.B. HOBBS, P.E.
DIVISION PROJECT TEAM LEAD

CHRIS SLACHTA
DIVISION PROPOSALS ENGINEER

S.P. FENWICK, PLS
DESIGN ENGINEER

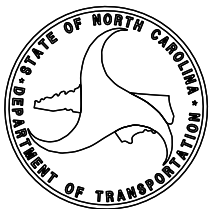

18-APR-2022 09:15
 C:\Users\bkbrown5\Desktop\Misc. Projects\Martin\NC 44-HWY 11 Centerline Rumble Strips\Design Files\DA00526-SINUSOUDAL RUMBLE STRIPS.dgn
 \$\$\$USERNAME\$\$\$

STATE	STATE PROJECT REFERENCE NO.	SHEET NO.
N.C.	44847.3.6	3
STATE PROJ. NO.		DESCRIPTION
44847.3.6		PE, CONST

STATE OF NORTH CAROLINA
DIVISION OF HIGHWAYS

HERTFORD COUNTY

LOCATION: NC 11 FROM HERTFORD COUNTY LINE TO SR 1130 (EAST MODLIN RD)

TYPE OF WORK: SINUSOUDAL MILLED RUMBLE STRIPS & INSTALL SNOW PLOWABLE MARKERS

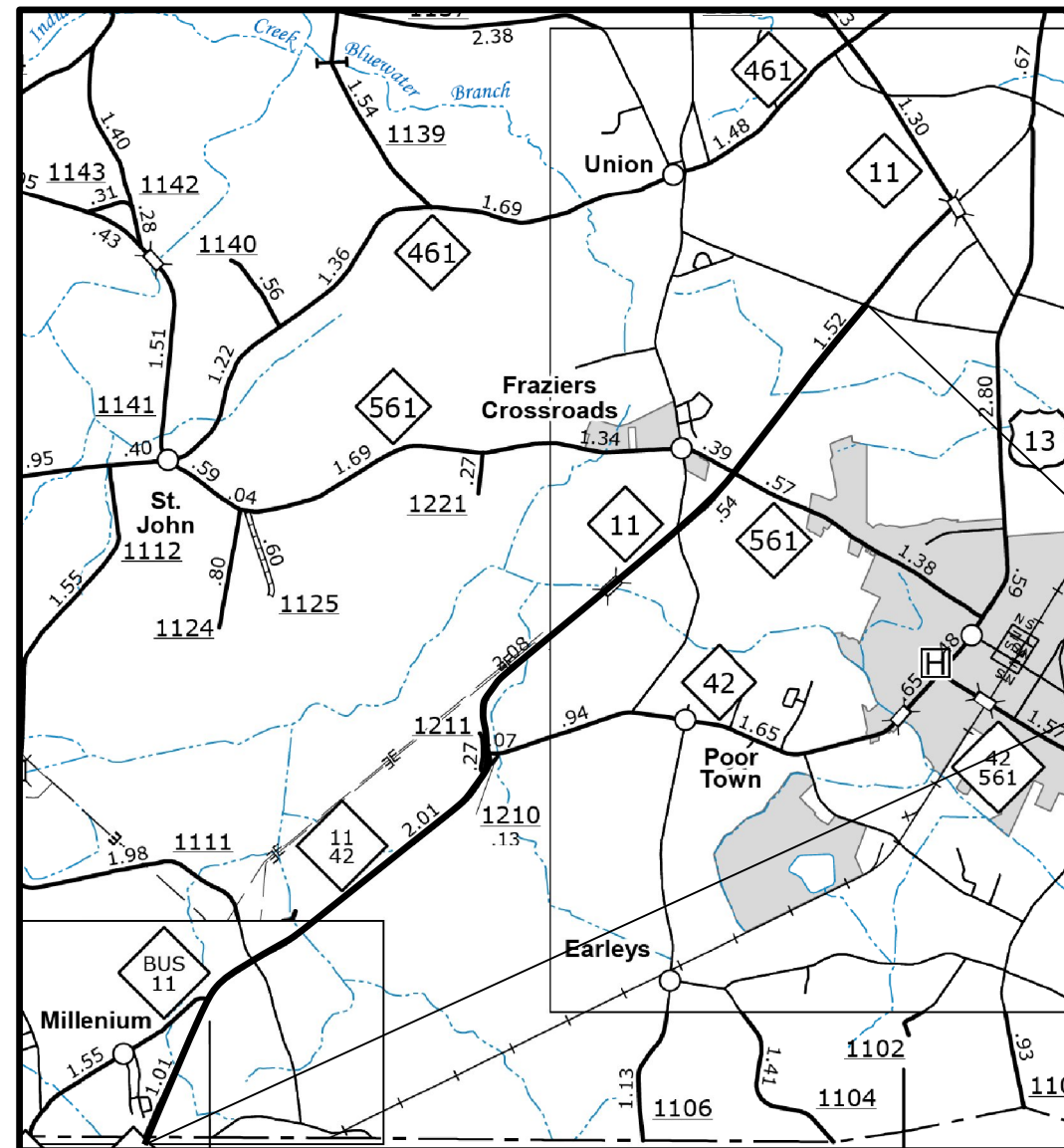

CONTRACT: DA00526 WBS PROJECT: 44847.3.6

GRAPHIC SCALES

NTS

PROJECT LENGTH

LENGTH ROADWAY MAP #3 = 9.0 MILES

Prepared in the Office of:
DIVISION OF HIGHWAYS
113 AIRPORT DR., EDENTON, NC, 27932

2018 STANDARD SPECIFICATIONS

W.B. HOBBS, P.E.
DIVISION PROJECT TEAM LEAD

CHRIS SLACHTA
DIVISION PROPOSALS ENGINEER

S.P. FENWICK, PLS
DESIGN ENGINEER

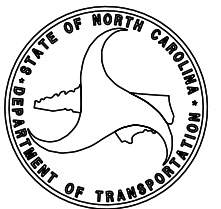

03-MAY-2022 10:18 C:\User\sbk\prow5\Desktop\Misc. Projects\Martin\DA00526 NC 44-HWY 11 Centerline Rumble Strips Design Files\DA00526_SINUSOUDAL RUMBLE STRIPS MAPS.dgn \$\$\$USERNAME\$\$\$

NOTES:

- 1) USING A VACUUM IN THE SAME OPERATION, REMOVE ALL DEBRIS FROM THE MILLINGS JUST PRIOR TO PLACING ANY PAVEMENT MARKINGS.
- 2) ENSURE GLASS BEADS AND HIGHLY REFLECTIVE MEDIA ARE SPREAD UNIFORMLY OVER THE ENTIRE SURFACE OF THE PAVEMENT MARKINGS.
- 3) EXISTING SNOWPLOWABLE MARKERS ARE INSTALLED ON APPROXIMATELY 80' INCREMENTS. DO NOT MILL RUMBLE STRIPS IN SECTION WHERE RAISED MARKERS ARE INSTALLED.
- 4) IF SNOWPLOWABLE MARKERS ARE TO BE INSTALLED IN THE CENTERLINE, SKIP A 24" SPACE IN THE RUMBLE STRIPES EVERY 40' OR 80' ACCORDING TO STD. 1250.1

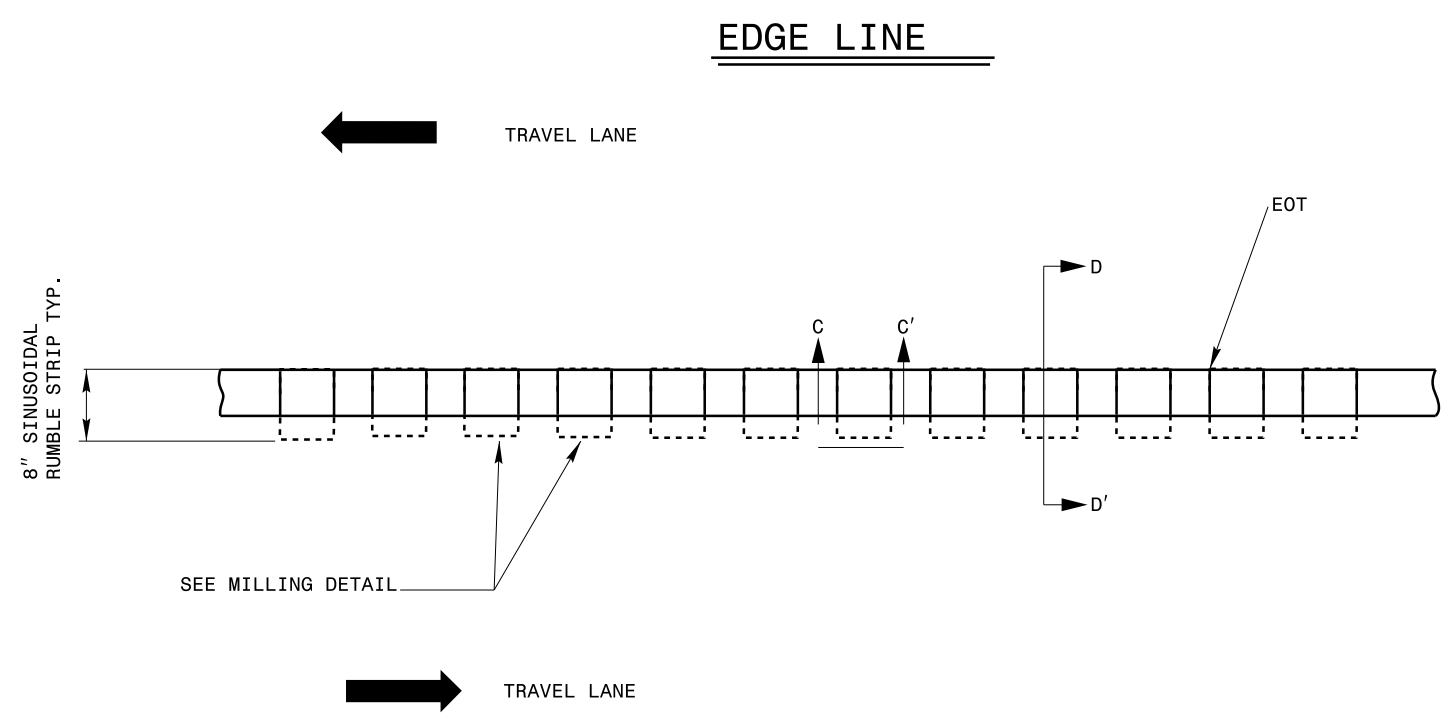
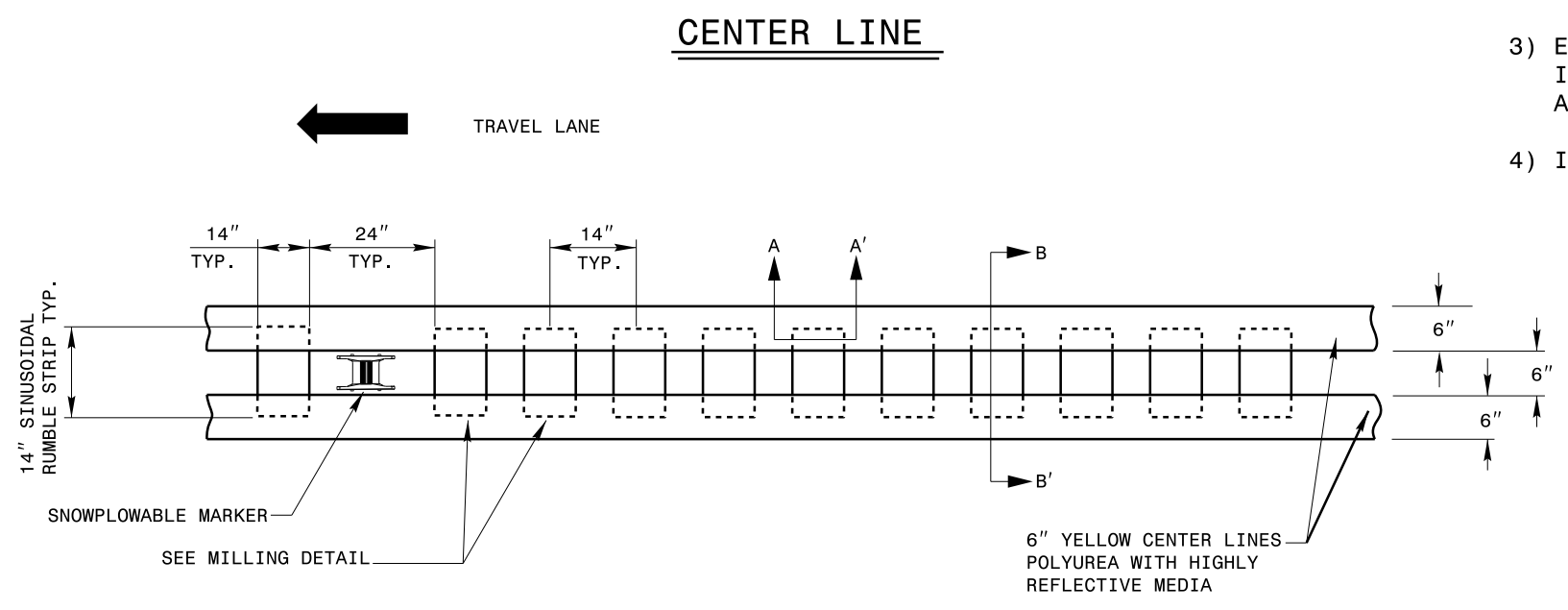

MILLING/MARKING DETAILS

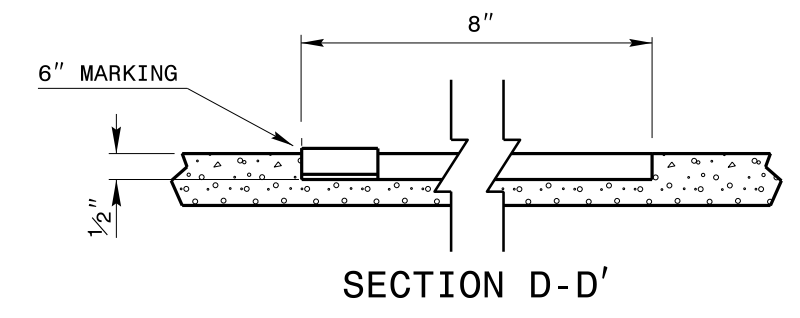
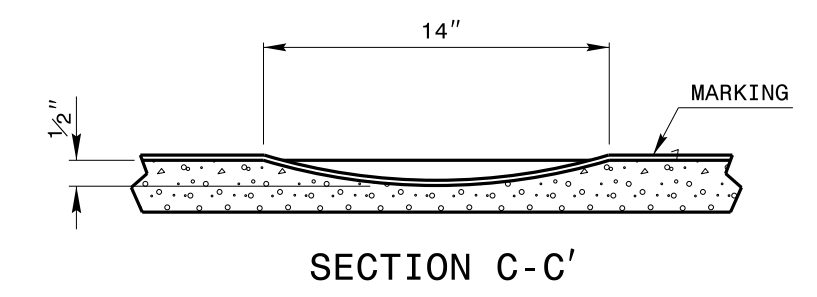
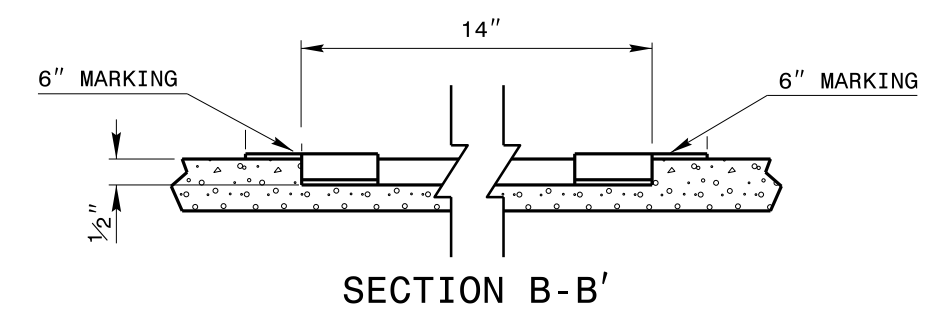
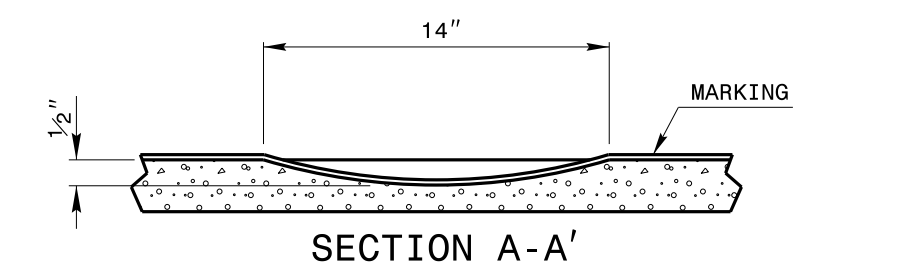

09-MAY-2022 14:06 St. Contr. Files\0526 NC 44-HWY 11 Centerline Rumble Strips\Design Files\Milled Center Rumble Strips.dgn

P A V E M E N T S C H E D U L E

M	SINUSOIDAL MILLED RUMBLE STRIPS
HSTPM	HOT-SPRAY THERMOPLASTIC MARKING ITEM (6", 55 MILS)

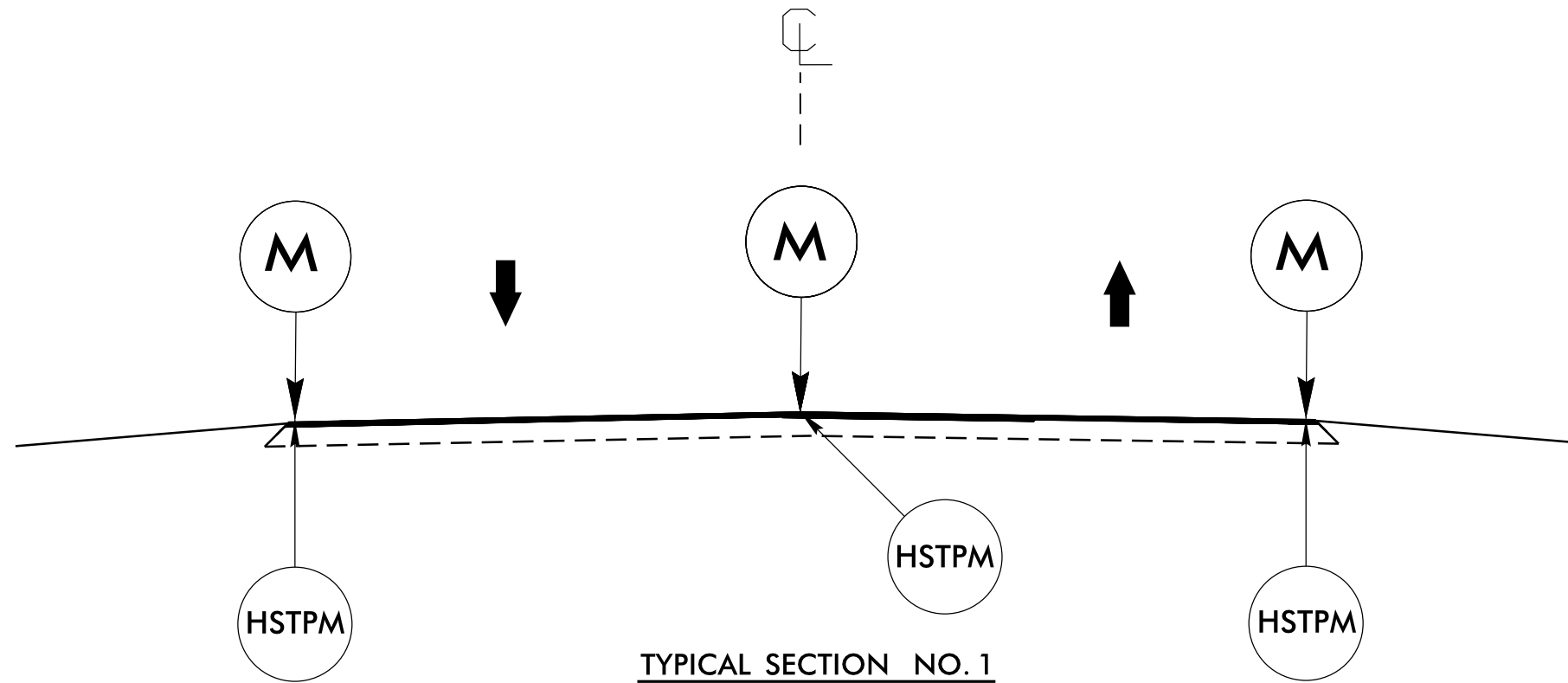

TYPICAL SECTION NO. 1
USE WITH MAPS : 1-3

09-MAY-2022 14:14
 S:\Projects\0400526 NC 44-HWY 11 Centerline Rumble Strips\Design Files\0400526.D1addc.TYP.dgn
 \$FILE\$

SIGNING FOR RESURFACING PROJECTS

LEGEND

⊥ STATIONARY SIGN

← DIRECTION OF TRAFFIC FLOW

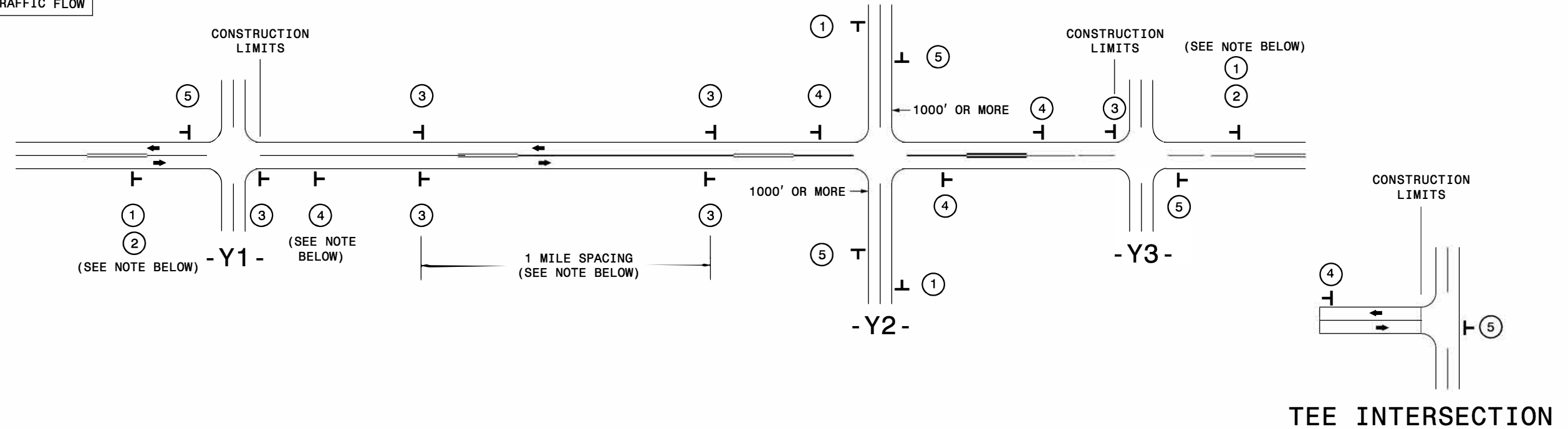

MAINLINE (-L-) SIGNING

-Y- LINE SIGNING

SIGNING NOTES AND PLACEMENT PER DIRECTION	①		PLACE 1000' PRIOR TO BEGINNING OF CONSTRUCTION LIMITS. ONLY USED ON -Y- LINES IF RESURFACING LIMITS EXTEND 1000' ALONG -Y- LINE.
	②		#2 SIGN ONLY USED WHEN CONSTRUCTION LIMITS ARE 2 OR MORE MILES IN LENGTH. ROUND UP TO NEXT WHOLE NUMBER. (NO FRACTIONAL OR DECIMAL NUMBERS)
	③		<ul style="list-style-type: none"> - PLACE INITIALLY AT THE CONSTRUCTION LIMITS AND SPACE 1 MILE APART THEREAFTER. - AT TEE INTERSECTIONS INSTALL INITIALLY 1/2 MILE FROM INTERSECTION AND SPACE 1 MILE APART THEREAFTER.
	④		<ul style="list-style-type: none"> - THESE ARE FOR -Y- LINES THAT ARE "THROUGH" ROADWAYS. - DEAD END AND SUBDIVISION ROADS ARE NOT "THROUGH" ROADWAYS. - INSTALL 500' +/- FROM EACH -Y- LINE APPROACH AS SHOWN ABOVE. - FOR MULTIPLE -Y- LINES THAT ARE SEPARATED BY 0.25 MILES OR LESS, TREAT AS A SINGLE UNIT AND INSTALL WITHIN 500' OF EACH APPROACH. - A MAXIMUM OF 2 SIGN SETS PER MILE. DO NOT INSTALL WHEN -Y- LINES ARE WITHIN 0.5 MILES FROM "END ROAD WORK" SIGN. - FOR TEE INTERSECTIONS, INSTALL WITHIN 500' +/- OF THE INTERSECTION ALONG -L- LINE.
	⑤		PLACE 500' FOLLOWING THE END OF CONSTRUCTION LIMITS OR AS SHOWN WHEN WORK ENDS AT A 3-WAY TEE INTERSECTION.
<p>THE ABOVE SIGNS ARE ALL THAT ARE REQUIRED FOR A CONTRACTOR TO BEGIN A RESURFACING CONTRACT. ANY ADDITIONAL SIGNS REQUESTED BY NCDOT DIVISIONS SHALL BE INSTALLED WITHIN 7 BUSINESS DAYS OF THE START OF CONTRACT WORK.</p>			
<p>FOR RESURFACING MAPS WITH CONSTRUCTION LIMITS LESS THAN 2 MILES IN LENGTH, NO STATIONARY SIGNS ARE REQUIRED. USE PORTABLE "ROAD UNDER CONSTRUCTION" OR "ROAD WORK AHEAD" SIGNS IN LIEU OF STATIONARY ADVANCE WARNINGS SIGNS.</p>			

NO REQUIRED STATIONARY SIGNING FOR THE FOLLOWING -Y- LINE CONDITIONS:

- 1) LESS THAN 1000' OF RESURFACING ALONG -Y- LINE
- 2) SUBDIVISION ROADS
- 3) DEAD END ROADS

WHEN PAVING/CONSTRUCTION ACTIVITIES PROCEED ACROSS AN UNSIGNED -Y- LINE, PORTABLE ADVANCE WARNING SIGNS SHALL BE USED ALONG THE -Y- LINE AS SHOWN BELOW. REMOVE UPON COMPLETION OF WORK.



**ADVANCE WARNING SIGNS
FOR
RURAL AND SUBURBAN
2-LANE ROADWAY
RESURFACING**

I:\APR-2022_09\43 C:\Users\jmartin\OneDrive\Desktop\Misc. Projects\Martin\NC 44-HWY 11\Centerline Rumble Strips\Design Files\DA00526_SINUSOLIDAL RUMBLE STRIPS MAPS.dgn
 \$\$\$USERNAME\$\$\$

**MAPS LESS
THAN 2 MILES**

PROJECT NO.	SHEET NO.
W5701-F	7

SUMMARY OF QUANTITIES

PROJECT NO	COUNTY	MAP NO	ROUTE	DESCRIPTION	TYP NO	LANES	LANE TYPE	FINAL SURFACE TESTING REQUIRED	WARM MIX ASPHALT REQUIRED	LENGTH		MOBILIZATION	GENERIC PAVING ITEM (SINUSOIDAL MILLED RUMBLE STRIP 14")	GENERIC PAVING ITEM (SINUSOIDAL MILLED RUMBLE STRIP 8")	WORK ZONE ADVANCE/GENERAL WARNING SIGNING	TEMPORARY TRAFFIC CONTROL (SP)	PAINT PAVEMENT MARKING LINES (4") WHITE	PAINT PAVEMENT MARKING LINES (4") YELLOW	GENERIC PAVEMENT MARKING ITEM, THERMO HOT SPRAY LINES (6" 55 MILS) WHITE	GENERIC PAVEMENT MARKING ITEM, THERMO HOT SPRAY LINES (6" 55 MILS) YELLOW	GENERIC PAVEMENT MARKING ITEM, NON-CAST IRON SNOWPLOWABLE PAVEMENT MARKER
										MI	FT										
44847.3.6	Martin	1	NC11	HWY 903 TO MARTIN / BERTIE COUNTY LINE	1	2	2WU	NO	NO	2	25	1	10,560	21,120	300	1.00	21,120	13,200	21,120	13,200	160
44847.3.6	BERTIE	2	NC11	MARTIN/BERTIE COUNTY LINE TO BERTIE/HERTFORD COUNTY LINE	1	2	2WU	NO	NO	17	25	*	89,760	179,520	300	*	179,520	112,200	179,520	112,200	1,360
44847.3.6	HERTFORD	3	NC11	HERTFORD COUNTY LINE TO EAST MODLIN RD/ NC 11 INTERSECTION	1	2	2WU	NO	NO	9	25	*	47,520	95,040	300	*	95,040	59,400	95,040	59,400	720
TOTAL FOR PROJ NO. W5701-F										28		1	147,840	295,680	900	1	295,680	184,800	295,680	184,800	2,240
																	480,480	480,480			